

ए. ए. आ.

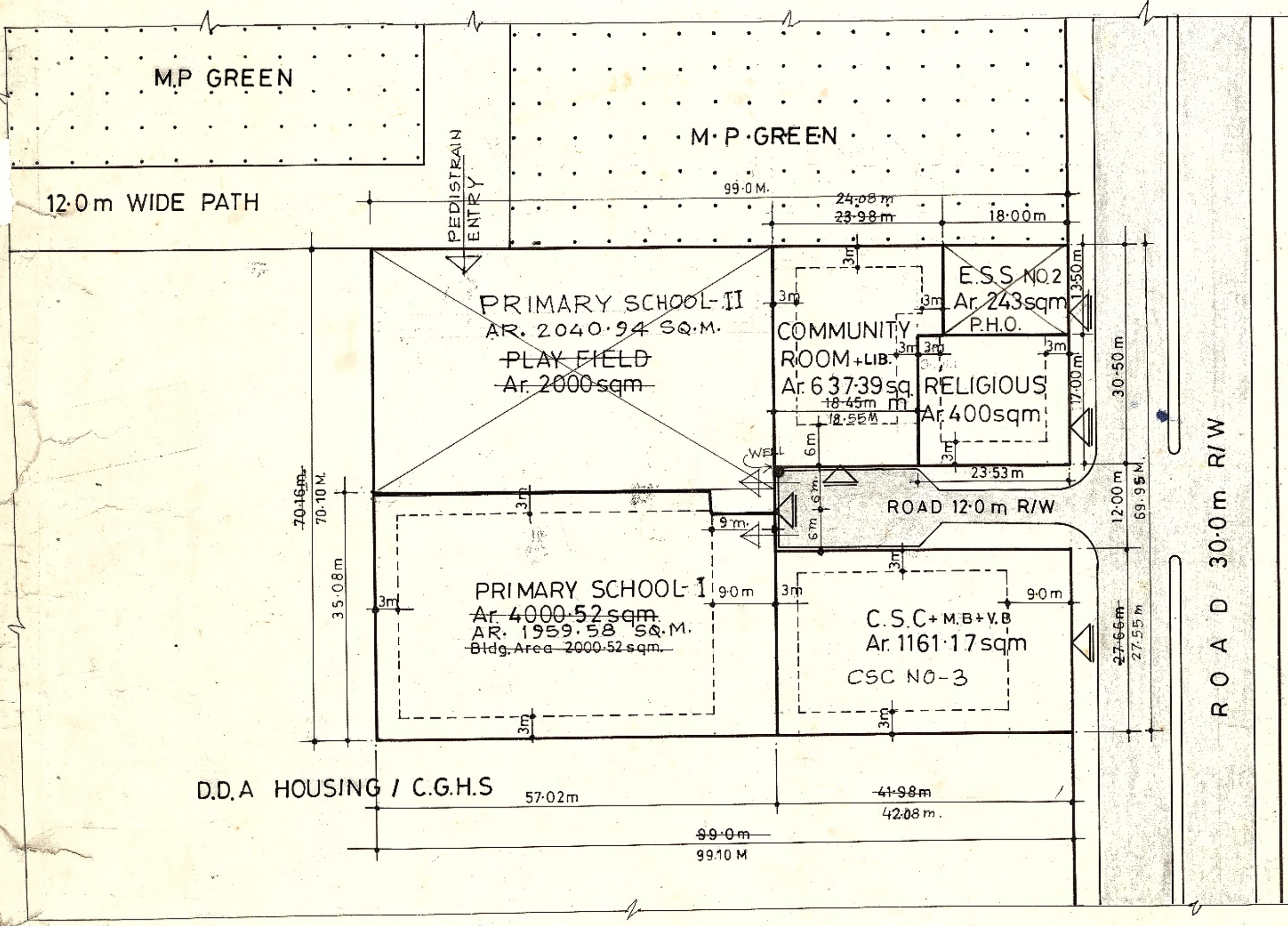

RAILWAY TRACK 30.0m WIDE

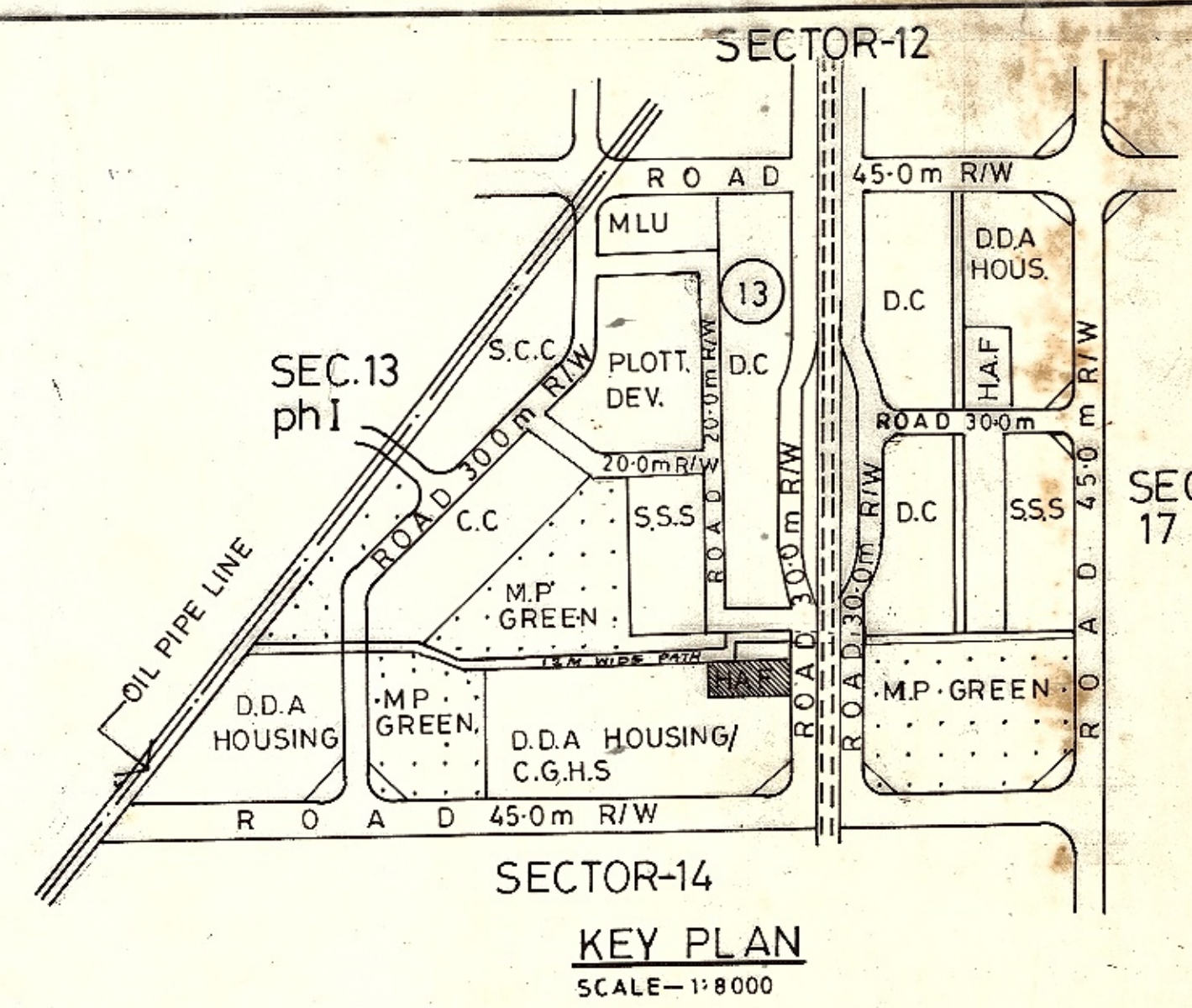

AREA STATEMENT:-
TOTAL AREA OF THE SITE = 6945.84 sqm.
Detail of area as under:-

Sl no	Facility	Proposed Area in sqm (each plot)	Grd. Covr.	FAR	Max. Ht.
1.	PRIMARY SCHOOL I-	1959.58	33%	100	14m
	II-	4000.52			
2.	C.S.C+M.B+V.B	1161.17	40%	60	8 m
3.	C.R + LIBRARY	637.39	33.33%	66.66	8 m
4.	RELIGIOUS	400.00	33.33%	66.66	8 m
5.	E.S.S	243.00			
6.	CIRCULATION	503.76			

TOTAL = 6945.84

OTHER NORMS AS PER MPD 2001

- NOTES:-**
- ALL DIMENSIONS ARE IN METRE.
 - DO NOT SCALE THE DRAWING FOLLOW ONLY THE WRITTEN DIMENSIONS.
 - CHECK ALL DIMENSIONS AT THE SITE BEFORE EXECUTION.

APPROVED BY COMMISSIONER (PLNG) ON 06.11.11 IN FILE NO. F8(10)/94/DN HAF-2/PART-I.

* INCORPORATED THE SURVEY DIMENSION IN LOP OF HAF AS PER DIMENSIONS SUPPLIED BY J.A. DIR (S) UNIT IN ROUGH SKETCH PLAN DT. 18-12-02 (PAGE 67)

- THE PLAN IS SUBJECT TO MODIFICATIONS WITHIN THE FRAMEWORK OF MASTER PLAN/ZONAL PLAN.
- IT IS FOR PLANNING PURPOSE & IS NOT FIT TO BE PRODUCED IN THE COURT OF LAW FOR PROPERTY DISPUTES.
- ALL THE DIMENSIONS & AREA GIVEN IN THE PLAN ARE SUBJECT TO CONFIRMATION OF OWNERSHIP/ALLOTMENT STATUS AND DEMARCATIONS/FEASIBILITY REPORT FROM THE DDA LANDS & ENGINEERING WING RESPECTIVELY.

SUB-DIVISION OF PRIMARY SCHOOL SITE APPROVED IN THE 285th SCREENING COMMITTEE HELD ON 19-11-09 VIDE ITEM NO. 156/09. THE DEVELOPMENT CONTROL NORMS AND SET BACKS WILL BE AS PER PREVAILING MPD.

LAY OUT PLAN OF H.A.F. SECTOR-13 PHASE-II

IDWARKA SUB-CITY (P.P.K.)

PROPOSED HOUSING AREA FACILITY (c)		
10 5 0 10 20	1:500 SCALE	DWW SEC-13/HAF/95/11 Drq.no-
RAJENDER KUMAR Plg. d/man.	Plg. asstt.	APRIL 95 Date-
T. SINGH Asstt. director.	ANIL BARAI Joint director.	S. SRIVASTAVA Director.(plg)
DELHI DEVELOPMENT AUTHOR		